

## ROCKWHEEL SERVICE DOCUMENT

### Drum Removal for D20 & D30 Direct Drive Rockwheel

#### Tools needed for repair

- Parts Manual for your unit
- M20/17mm allen socket
- M16/14mm allen socket
- M16 lifting eyebolts or straps

For this procedure refer to pages labeled D30-7 or D20-7 in the parts manual.

1. Lay unit over with the Motor side drum or return side of the cutter facing upward.
2. Begin removing the drum end cap (Item 3, figure 1) by removing the four M16x40mm bolts (Item 6 on figure 1).
3. Remove the eight M20x90mm bolts holding the drum down (Item 2, figure 1).
4. Remove the drum from the hub assembly using a strap or M16 lifting eyebolts using the holes from the drum cap (figure 2).

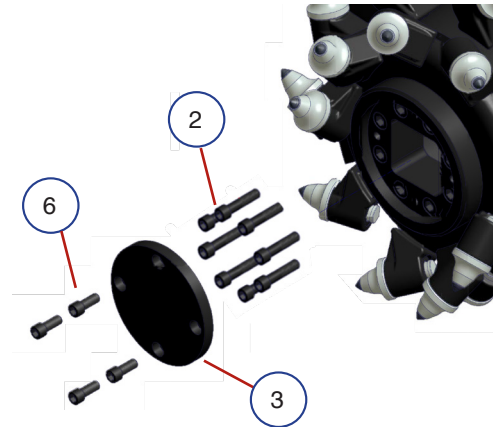

Figure 1. Drum and Drum Cover assembly



Figure 2. Remove drums

## ROCKWHEEL SERVICE DOCUMENT

### Drum Installation for D20 & D30 Direct Drive Rockwheel

#### Tools needed for repair

- Parts Manual for your unit
- M20/17mm allen socket
- M16/14mm allen socket
- M16 lifting eyebolts or straps

1. Reinstall your drum using the eight M20x90mm bolts. These should be torqued to 525 ft/lbs. **Item 2, figure 1.**
2. Now you can install the drum cap using the four M16x40mm bolts. These should be torqued to 269 ft/lbs. **Item 6, figure 1.**

The Rockwheel is now ready for deployment

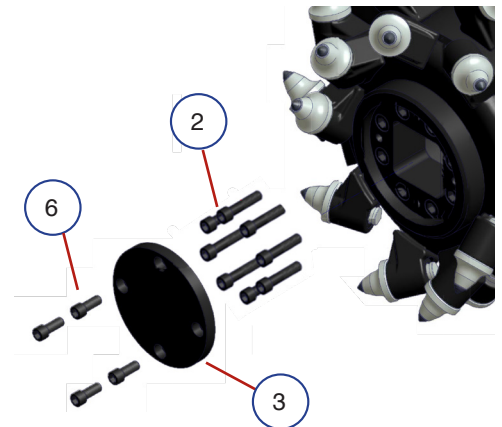

Figure 1. Drum and Drum Cover assembly

